

Hybrid FLOW[®]

Two in one



Improving the Shop Experience...

ITAB
SCANFLOW

HCO is two in one – from self-service to manned in seconds

CCO MODE

CCO mode = Manned mode, offers standard manned operation utilising existing POS system as today. Offering the best in checkout design and ergonomics to get the best from flow efficiency and operator satisfaction.

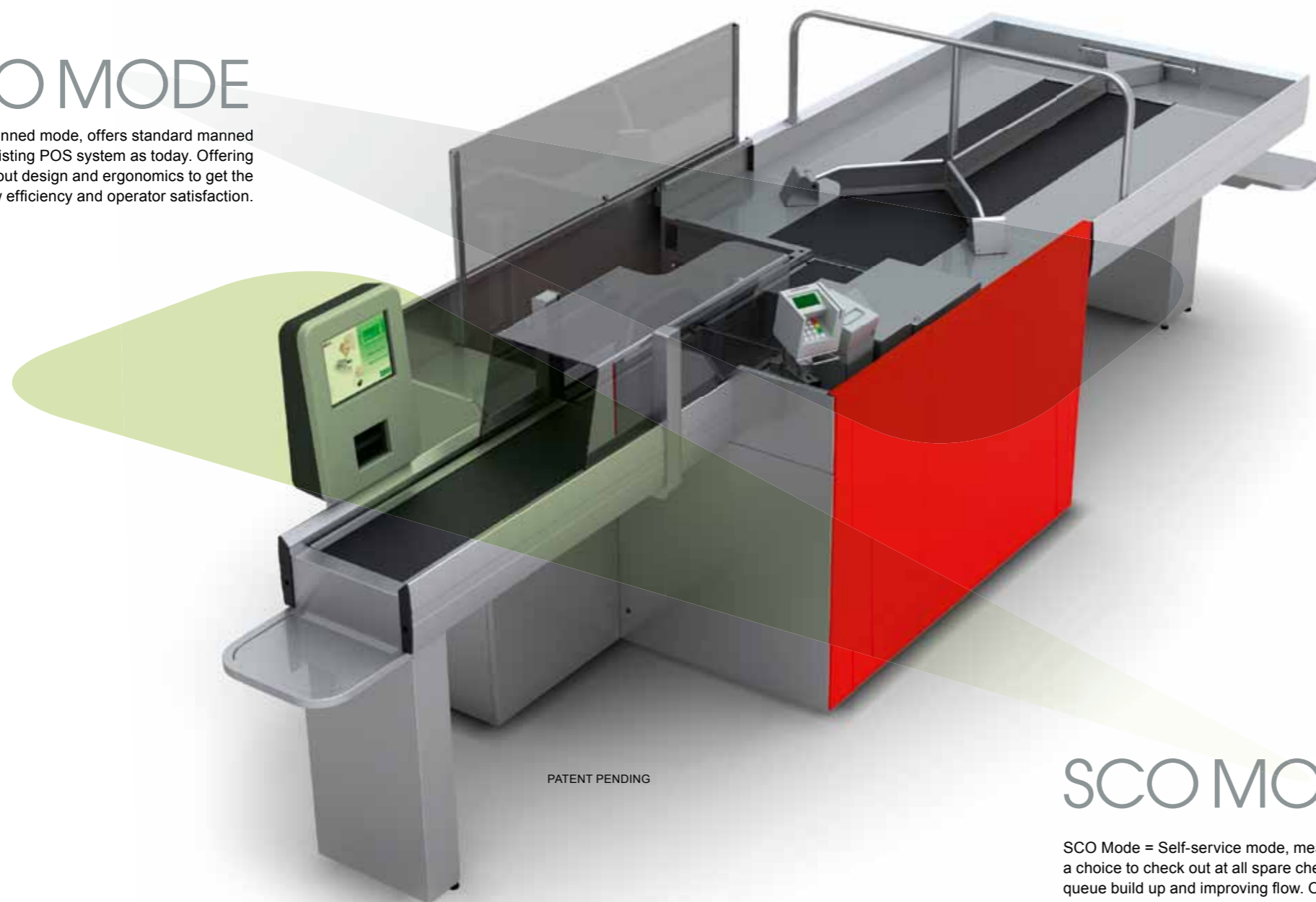

HCO is the combination of SCO = Self Check Out and CCO = Conventional Check Out in one unit, flexible to be changed from manned service to self-service in seconds.

ITAB HCO products makes it possible to have the high capacity of the most efficient manned checkout and when not manned be there for Self-service.

It means flexibility to meet the customer flow demand at high and low level with great cost efficiency and customer satisfaction.

ITAB Scanflow presents one System in two Concepts. We have chosen to base one concept on the belted SCO model TwinFlow and second concept on our most efficient CCO's F2000 and Checkmate. Both concept's have the same software- and hardware-system that makes the first true HCO in the market with highest efficiency, flexibility and built in security.

- Unique on the market, "The First true HCO"
- Offers totally new possibilities for the retailer
- Perfect for all stores and especially for high volume transactional retailers
- Makes the step to SCO much easier as the customer has a consistent checkout experience

SCO MODE

SCO Mode = Self-service mode, means that shoppers have a choice to check out at all spare checkouts allowing minimal queue build up and improving flow. Our intuitive and easy to use solution that guides the shopper through the checkout experience for both basket and trolley shoppers.

HYBRID CHECK OUT PRESENTED IN THREE DESIGNS

A common component for all the HCO solutions is the SCO mode functionality. It's a complete, efficient self checkout system, including fraud preventive with a self learning weigh control system and light curtain tunnel for additional security.

With our SCRIP interface protocol you can integrate to the POS to extend the required SCO functions.

The SCO mode is operated with direct links to the POS system and utilizes all current logic and peripherals that are in use in the actual CCO.

F2000^{HCO}



Based on the ITAB CCO model F2000, high quality, attractive design with a focus on operator ergonomics and shopper efficiency, built in Finland. F2000 HCO is 100% CCO and 100% SCO. Read more about the model on page 5.

CheckMATE^{HCO}



Based on the ITAB CCO model CheckMate, high quality, slim, smart and sharply organises and clearly straightens out the checkout area. Design with a focus on operator ergonomics and shopper efficiency. CheckMate HCO is 100% CCO and 100% SCO. Read more about the model on page 6.

TwinFLOW^{HCO}



Based on ITAB Scanflow SCO model TwinFlow with proven technology and used as the shining example of intuitive and easy to use design as it responds and resolve frequent customer mistakes. TwinFlow HCO is a unique twin belted SCO addressing many of the issues retailers have with a trolley based SCO, it's a 100% SCO and 70% CCO as we recommended it for standing or short term sitting. Read more about the model on page 7.

F2000^{HCO}

Based on the ITAB CCO model F2000, high quality, attractive design with a focus on operator ergonomics and shopper efficiency, built in Finland. F2000 HCO is 100% CCO and 100% SCO.



SCANNER - BELT-SCALE

This is the Scanner for all items with barcode. A hand scanner can be added for large and bulky items. On F2000 HCO Dynamic fruit and vegetables are reliably weighed on the certified belt scale, together with the choices the customer makes on the Dynamic GUI screen for loose weight products like fruit and vegetables.

BASKET SHELF

Designed for arranging different basket sizes or trolley. This is the first thing the customer meets when starting up the Self Checkout (SCO) process. It's easy to identify and together with a welcoming screen message it guarantees a natural flow for the user.

"3rd CUSTOMER FUNCTION"

To increase the checkout speed in CCO mode a "3rd customer" solution is adapted which makes it possible to start as a 3rd customer when the two previous have moved on to pack their articles into bags at the packing shelf. It makes a smooth working flow for the cashier with higher efficiency.

PATENT PENDING

Customer interaction in SCO mode

Our SCO solution is a complete, efficient, self checkout system, including fraud preventive with a self learning weigh control system and light curtain tunnel for additional security.

It suits both basket and trolley customers and has all the features required to handle different articles and buying functions. The system helps customers to avoid user errors.

If they put items on the belt without scanning they receive a prompt on the screen to scan the item first. If the customer scans one item twice and puts it's on the belt – one will be added to the bill NOT two. If the customer scans two items and puts them on the belt – the weights are added together and they are accepted and added to the bill. It can easily be used by customers of all ages.

If the customer does get a problem as a result of incorrect scanning, the system notifies the attendant to help without embarrassing the customer.



FLEXIBLE CUSTOMER INTERFACE

A multi language and customer guidance function makes it easy to understand and use. The GUI screen, instructs and interacts with the user all the way and the screen contains all the necessary commands.



DYNAMIC CONTENT

Customer choices can be displayed depending on shopping process for fruit and vegetables and reliably weighed on the certified belt scale.



PAYMENT

The customer pays with a debit card in the F2000 HCO or cash in the PayFlow and receives an exit receipt. For simplicity we always use the EFT and receipt printer already linked to the shop's POS-system, certified by local tax authorities.



F2000 HCO ADVANTAGES FOR A HCO BASED ON A CCO SOLUTION



- Superior ergonomics in CCO mode
- Highest efficiency:
 - CCO mode with the latest technology
 - In CCO mode with 3rd customer solution and SCO mode with 2nd customer solution
- High efficiency and security by complete integration of ITAB SCO Flow hardware- and software
- Easy to understand for previous non SCO users by working the same way as existing solutions and meeting the traditional look of CCO as in SCO mode
- Prepared as the same designed CCO for all peripherals and systems needed for full functionality and ergonomics:
 - CCO cockpit with full POS operation
 - SCO with full SCO operation
 - Prepared for integrated cash management systems for CCO mode
- Recommended in combination with ordinary CCO in same design to keep the Checkout area aesthetically "together" and get familiarity feeling with low SCO entrance acceptance level

FOR TECHNICAL FACTS SEE PAGE 12

CheckMATE HCO™

Based on the ITAB CCO model CheckMate, high quality, slim, smart and sharply organises and clearly straightens out the checkout area. Design with a focus on operator ergonomics and shopper efficiency. CheckMate HCO is 100% CCO and 100% SCO.



PATENT PENDING

BASKET SHELF

Designed for arranging different basket sizes or use of trolley. This is the first thing the customer meets when starting up the Self Checkout (SCO) process. It's easy to identify and together with a welcoming screen message it guarantees a natural flow for the user.

SCANNER - BELT-SCALE

This is the Scanner for all items with barcode. A hand scanner can be added for large and bulky items. On CheckMate HCO Dynamic fruit and vegetables are reliably weighed on the certified belt scale, together with the choices the customer makes on the Dynamic GUI screen for loose weight products like fruit and vegetables.

"3rd CUSTOMER FUNCTION"

To increase the checkout speed in CCO mode a "3rd customer" solution is adapted which makes it possible to start as a 3rd customer when the two previous have moved on to pack their articles into bags at the packing shelf. It makes a smooth working flow for the cashier with higher efficiency.

CCO MODE

Offering the best in checkout design and ergonomics to reach highest flow efficiency and operator satisfaction.



TwinFLOW HCO®

Based on ITAB Scanflow SCO model TwinFlow with proven technology and used as the shining example of intuitive and easy to use design as it responds and resolve frequent customer mistakes.

TwinFlow HCO is a unique twin belted SCO addressing many of the issues retailers have with a trolley based SCO, it's a 100% SCO and 70% CCO as we recommended it for standing or short term sitting.

"2ND CUSTOMER FUNCTION"

To increase the checkout speed in both CCO and SCO mode a "2nd customer" solution is adapted which makes it possible to start as a 2nd customer when the first have moved on to pack their articles into bags at the packing shelf. It makes a smooth working flow with high efficiency.

CCO MODE

CCO mode = Manned mode, offers standard manned operation utilising existing POS system as today.. Offering the best I checkout design and ergonomics to get the best from flow efficiency and operator satisfaction.



SCANNER - BELT-SCALE

This is the Scanner for all items with barcode.

A hand scanner can be added for large and bulky items. On TwinFlow HCO Dynamic fruit and vegetables are reliably weighed on the certified belt scale, together with the choices the customer makes on the Dynamic GUI screen for loose weight products like fruit and vegetables.

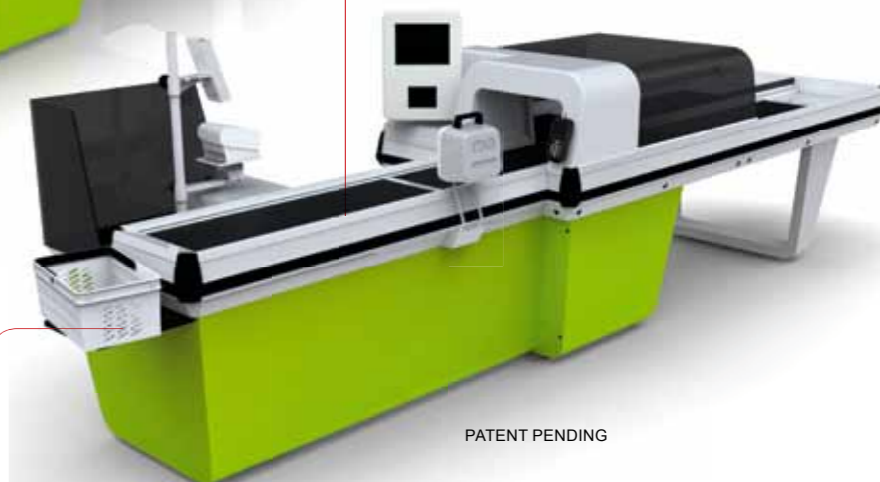

PATENT PENDING

BASKET SHELF

Designed for arranging different basket sizes or trolley. This is the first thing the customer meets when starting up the Self Checkout (SCO) process. It's easy to identify and together with a welcoming screen message it guarantees a natural flow for the user.

CHECKMATE HCO ADVANTAGES FOR A HCO BASED ON A CCO SOLUTION



- Superior ergonomics in CCO mode
- Highest efficiency:
 - CCO mode with the latest technology
 - In CCO mode with 3rd customer solution and SCO mode with 2nd customer solution
- High efficiency and security by complete integration of ITAB SCO Flow hardware and software
- Easy to understand for previous non SCO users by working the same way as existing solutions and meeting the traditional look of CCO as in SCO mode

- Prepared as the same designed CCO for all peripherals an systems needed for full functionality and ergonomics:
 - CCO cockpit with full POS operation
 - SCO with full SCO operation
- Prepared for integrated cash management systems for CCO mode

FOR TECHNICAL FACTS SEE PAGE 12

TWINFLOW HCO ADVANTAGES FOR A HCO BASED ON A CCO



- High SCO efficiency:
 - Efficient in both SCO and CCO mode with 2nd customer solution
- Easy to change from SCO to CCO mode and reversed
- Easy to use and understand, customer helping
- Out feed that transports products to the end all for maximum convenience and a minimum of floor width needed

- Efficient in learning system of SCO for all staff, using same interface as customers and learn to operate administration mode
- Flexibility; start with a TwinFlow and add the cockpit for HCO later 100% SCO proven functionality
- Inviting, distinct and modern design; easy for the customer to identify that this checkout is "different" and "Self-service"

FOR TECHNICAL FACTS SEE PAGE 12

Two in one – from SCO to manual CCO in seconds

SCO MODE



IMPULSE PURCHASE MERCHANDISING

Adjustable shelves on the front to aid impulse sales. As you can see on the different pictures size of the shelf depends on if it's a card only solution or if cash handling is built in for self service.



CCO MODE

CHANGE FROM CCO TO SCO AND REVERSED
This picture shows how the till bridge is moved from one position to the other and at the same time the function is switched from one mode to the other and user information is added in self service mode manually.



Do you want to reduce queuing, minimise the staff hours and give your express customers the option of a convenient checkout?

Our solution MoveFlow Hybrid Check Out gives you a maximum flexibility from manned checkout to Self to get the service that they deserve.

It's obvious that the situation with number of customers in convenient stores can change in seconds and the checkout must be ready to follow and meet the customer expectation of a convenient checkout. If not, customers might turn in the entrance or never come back again. It will be a change from increased to lost sales that never had to happen.

MoveFlow HCO helps you at low customer periods, and with one or maximum two staff persons, one manned and up to eight self service tills is open at the same time and when it comes to highest rush hours all can be manned for the maximal capacity.

CCO MODE - CONVENTIONAL CHECK OUT MODE – MANNED CHECKOUT MODE

- Hybrid Check Out Design - Dual SCO and CCO
- Improved throughput
- Merchandising space
- Potential of Media Sales
- Advertising vehicle
- Movable Centre Console switches mode
- Basket to Bag design
- Rear Storage capacity
- Local POS set up and Cash Drawer in CCO mode

SCO MODE – SELF CHECKOUT MODE – SELF SERVICE MODE

- Self-learning weight check system
- Touch screen with user guidance
- Simple Intuitive Graphical User Interface
- Certified Scale + Scanner
- Combined Bag base/ weigh Scale to reduce shrinkage
- Cash and Card Concept
- Improvement in checkout efficiency - Increase sales
- Reduce walkways and improvement in customer service - Increase sales

MoveFLOW HCO®



PAYMENT

The customer pays with a debit card or cash in the MoveFlow HCO depending of need and version. For simplicity we always use the EFT and receipt printer already linked to the shop's POS-system, certified by local tax authorities.

SCANNER - SCANNER-SCALE

This is the Scanner for all items with barcode. On MoveFlow Dynamic fruit and vegetables are reliably weighed on the certified scale, together with the choices the customer makes on the Dynamic GUI screen for loose weight products like fruit and vegetables.



FLEXIBLE CUSTOMER INTERFACE

Delivering a flexible user interface that is intuitive to use and engaging, is vital to a successful deployment. Creating a solution that delivers control to the retailer is another key ingredient, as to not increase the cost of ownership throughout solution lifecycle.

MoveFlow delivers:

- Intuitive and easy to use customer interface
- Multilingual functionality
- Flexibility to develop individual look and feel
- Flexibility to develop additional functionality
- Fully configurable loose item look up

MoveFlow HCO in card only version

Two operational modes depending on the checkout and queue management set up you require to make in your store. Here you have a picture of the "card only" version in the SCO mode. In CCO mode with all functionalities that your POS have is at place. A solution suitable where high volume card transaction to take place.

SCO MODE



CCO MODE

MoveFlow HCO in cash and card version

A second version that handles both card and cash in the SCO mode. Ideal if you have a high volume of cash paying customer.

Combinations of the two version might be right to match the needs. In CCO mode all functionalities that your POS have is in place.

BASKET SHELF

The shelf is made to serve the both checkout modes. As the bought articles will be placed at packing & weighing platform a small flow is created. When the first customer is ready and next one can enter with his basket.

INFO SIGN FOR CARD OR CASH

Communication is an important thing to make it clear to the user what service is available.

SCO MODE



BAG HOLDER

Another alternative to help manage the bought items on the packing & weighing platform is the use of a bag holder. We can customise various alternatives to suit differing bags and packing demands.

CHOICE OF MATERIAL

The MoveFlow HCO is made in steel painted in customer colors. The sides can be custom made in workable materials and colored on demand.

CASH HANDLING UNIT

The centre console integrates a smaller/simpler version of our PayFlow system. All integrated in our Linux based Flow Software platform and SCRIP protocol.



CCO MODE

FACTS

MoveFLOW HCO®

Measurements:
Height: 1630 mm
Width: 1280 mm
Depth: 900 mm

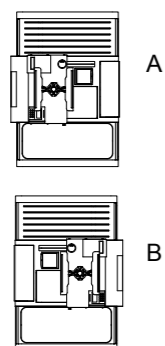

POWER SUPPLY/ELECTRICAL DETAILS:

European version:
Frequency: 50 Hz
Voltage: 230 VAC +/- 10%
Peak inrush current: 1 A (230VAC)
Nominal power (in use): 100 W +/- 10%
Absolute maximum power: 150 W +/- 10%

SCO Weighing system:
Weighing range: 5 to 20,000 grams
Weighing resolution: 1 gram

Dynamic Weighing system:
Weighing range: 5 to 15,000 grams
Weighing resolution: 1 gram
Certified scale in combination with Dynamic user GUI and a separate weighing display.

Hardware package:
1 SCO weighing scale
1 Dynamic weighing scale (for Dynamic option only)
1 TFT touch screen 15"
2 Barcode scanners
Prepared for installation of your own POS Hardware environment for use in CCO mode



CCO ATTEND SIDE
This is the reverse of the MoveFlow HCO unit.



F2000 HCO | F A C T S

Power supply/Electrical details:

European version:

Frequency: 50 Hz

Voltage: 230 VAC +/- 10 A (230VAC)

Standby (All motors off , rest on): 80 W +/- 10%

Nominal power (in use): 450 W +/- 10%

Absolute maximum power: 1180 W +/- 10%

Weighing system:

Weighing range: 5 to 15,000 grams

Weighing resolution: 1 gram

Hardware package:

Belt scale

Barcode scanner

TFT touch screen 15"

Prepared for installation of your own POS

Hardware environment for use in CCO mode

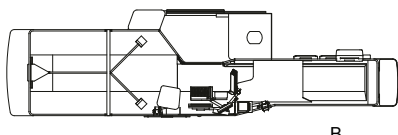
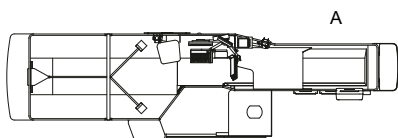

Measurements:

Length: Typical 5140 mm

or state range mm

Width: 1387

Height: 1460 mm



CHECK MATE HCO | F A C T S

Power supply/Electrical details:

European version:

Frequency: 50 Hz

Voltage: 230 VAC +/- 10 A (230VAC)

Standby (All motors off , rest on): 80 W +/- 10%

Nominal power (in use): 450 W +/- 10%

Absolute maximum power: 1180 W +/- 10%

Standard version:

Weighing range: 5 to 15,000 grams

Weighing resolution: 1 gram

Dynamic version: As standard but with certified

belt scale in combination with

Dynamic user GUI and a separate

weighing display.

Hardware package:

Belt scale

Barcode scanner

TFT touch screen 12"

Option: Second standard scale for use

in CCO mode

Prepared for installation of your own POS

Hardware environment for use in CCO mode

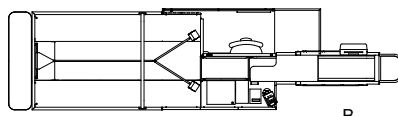
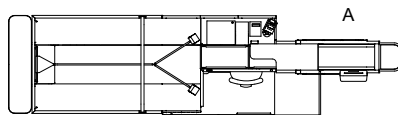

Measurements:

Length: Typical 5140 mm

or state range mm

Width: 1325 mm

Height: 1470 mm



TWIN FLOW HCO | F A C T S

Power supply/Electrical details:

European version:

Frequency: 50 Hz

Voltage: 230 VAC +/- 10 A (230VAC)

Standby (All motors off , rest on): 80 W +/- 10%

Nominal power (in use): 450 W +/- 10%

Absolute maximum power: 1180 W +/- 10%

Standard version:

Weighing range: 5 to 15,000 grams

Weighing resolution: 1 gram

Dynamic version: As standard but with certified

belt scale in combination with

Dynamic user GUI and a separate

weighing display.

Hardware package:

Belt scale

Barcode scanner

TFT touch screen 12"

Prepared for installation of your own POS

Hardware environment for use in CCO mode

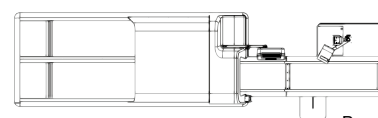
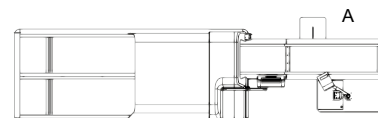

Measurements:

Length: Typical 4715 mm

or state range mm

Width: 1190 mm

Height: 1440 mm

NO STANDARD COLORS!

You decide exactly what color you want. As Europe's largest Conventional Check-out (CCO) manufacturer, we know the importance of design, function and customer flow. Together we create a Hybrid Checkout (HCO) unit that fits perfectly in your environment.